

4

3

2

1

THIS DRAWING IS UNPUBLISHED. RELEASED FOR PUBLICATION .19 .  
 © COPYRIGHT 19 BY AMP INCORPORATED. ALL RIGHTS RESERVED.

LOC	DIST	REVISIONS					
		P	LTR	DESCRIPTION	DATE	DWN	APVD
AF	50		C	REDRAWN & REV ON CAD PER 0G3A-0319-99	17DEC99	JR	DD
			C1	REVISED PER ECO-09-021510	08SEP09	KK	AEG

- 1 CONTINUOUS STRIP ON REELS
- 2 WIRE SIZE #30-#26 AWG.
- 3 INSULATION DIA IS 1.07-1.85 [.042-.073] DIA.
- ⚠4 PRELIMINARY - NOT FOR PRODUCTION
- ⚠5 OBSOLETE PARTS: OBSOLETE CIS STREAMLINING PER D.RENAUD/D.SINISI

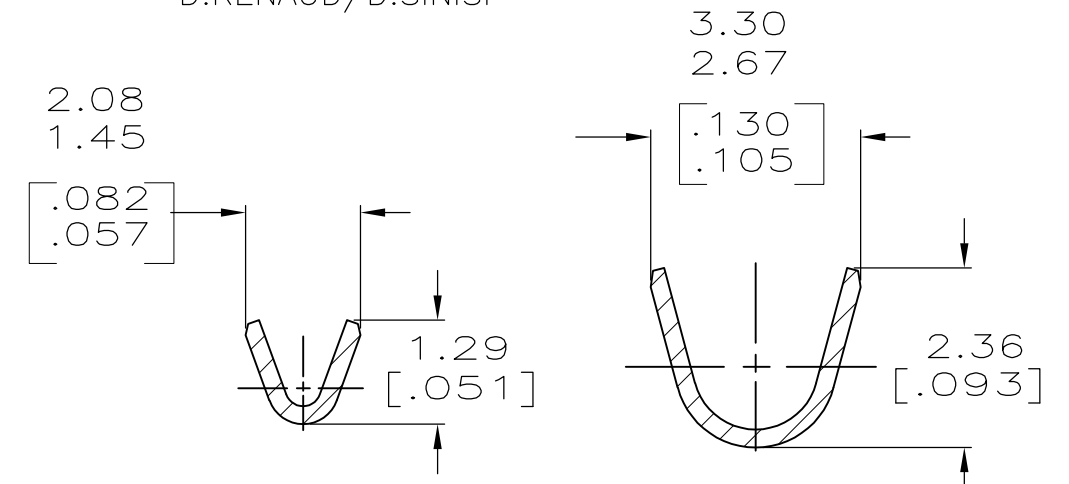
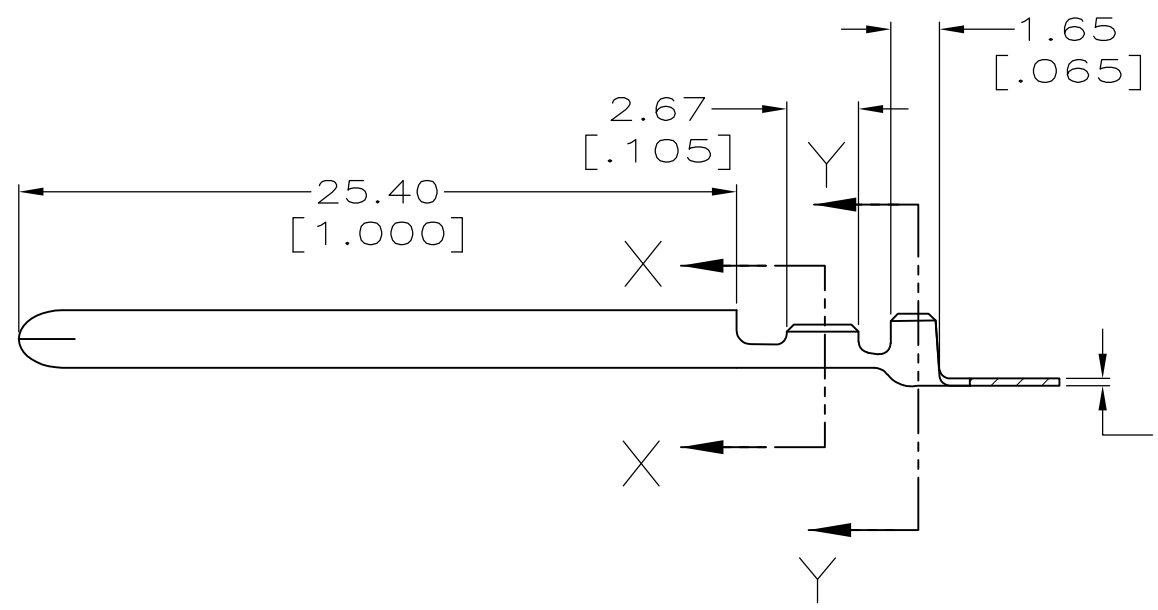
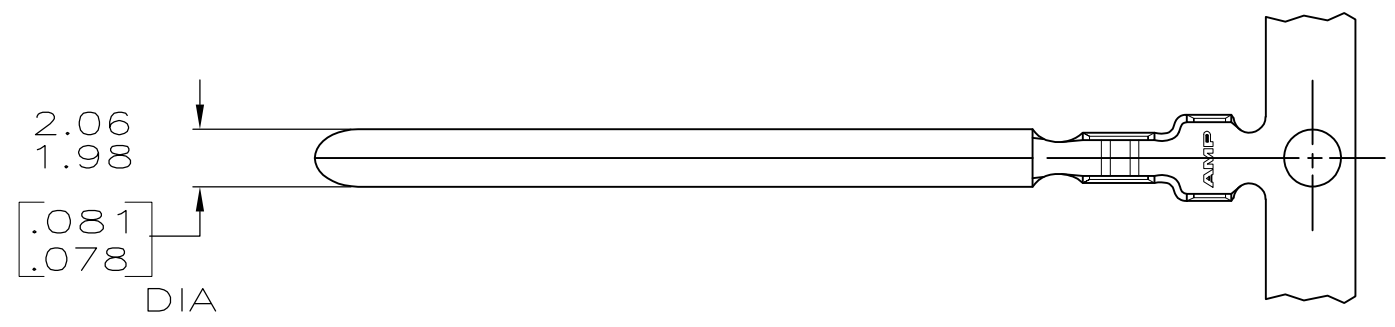

SECTION X-X SCALE 10:1  
SECTION Y-Y SCALE 10:1

⚠5 OBSOLETE	GOLD/TIN	⚠4 350053-3
	0.002032 [.000080] MIN TIN	350053-2
	FINISH	PART NO.

THIS DRAWING IS A CONTROLLED DOCUMENT.		DWN	JR RUTH	17DEC99	<b>AMP</b> AMP Incorporated Harrisburg, PA 17105-3608				
DIMENSIONS: MM [INCHES]		CHK	MS FEHER	17DEC99					
TOLERANCES UNLESS OTHERWISE SPECIFIED:		APVD	D DECKER	17DEC99	NAME				
0 PLC ±-		PRODUCT SPEC	-		PIN, 2.03 [.080] DIA				
1 PLC ±-		APPLICATION SPEC	-						
2 PLC ±0.38 [.015]		WEIGHT	-		SIZE	CAGE CODE	DRAWING NO	RESTRICTED TO	
3 PLC ±-		MATERIAL	082 BRASS	FINISH	SEE TABLE	A3	00779	C- 350053	-
4 PLC ±-									
ANGLES ±-		CUSTOMER DRAWING		SCALE	4:1	SHEET	1 OF 1	REV	C1