

### Extrusion

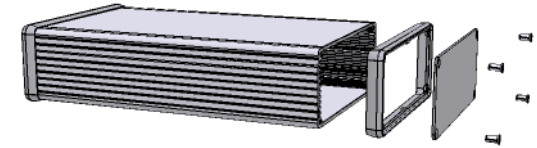

EXTRUSION DESIGNED FOR 120MM WIDE PC BOARD

### Slot Details

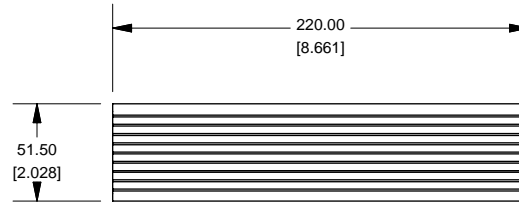
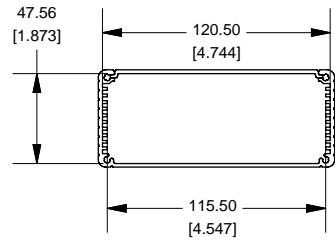
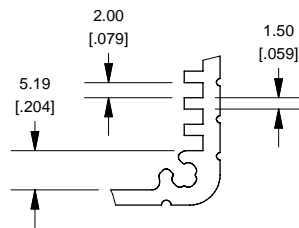

### End Plate

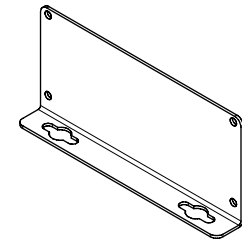
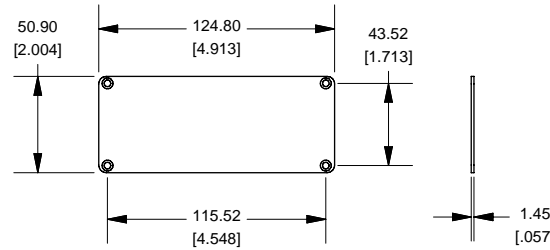

OPTIONAL FLANGE END PANEL  
1455QF

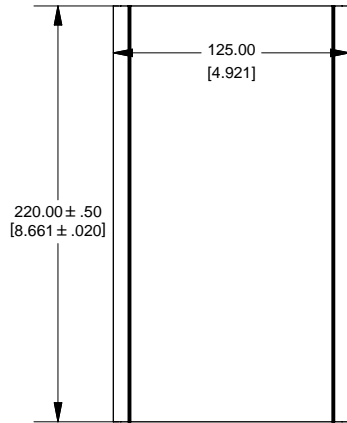

### Open Bezel

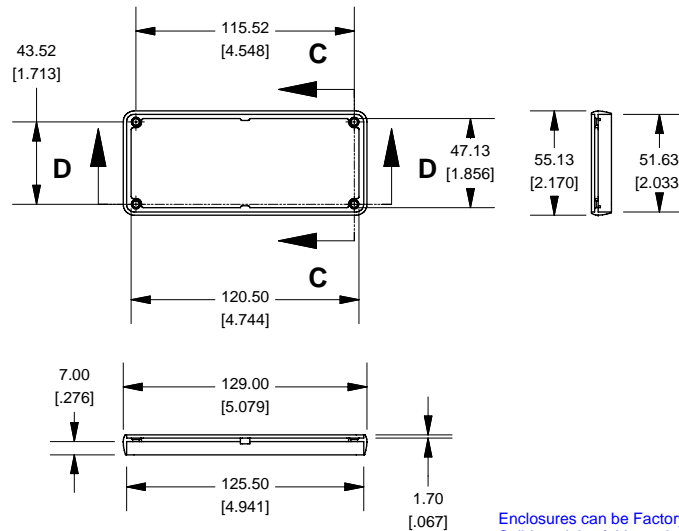

NOTE	
Purchased assembly includes box, plastic bezels, end panels, #6 Taptight screws and self adhesive rubber feet.	
Box made from Extruded Aluminum 6063.	
Bezels made with polycarbonate.	

1455Q2201	
PART NUMBERS	
Clear Anodized	1455Q2201
Black Anodized	1455Q2201BK
ACCESSORIES	
See website for accessories.	

**HAMMOND  
MANUFACTURING™**

**1455Q2201**  
www.hammondmfg.com

Enclosures can be Factory Modified ( Milling, Drilling, Printing etc. )  
Solid models of this enclosure available in STEP or IGES.  
Contact Factory [mjm@hammondmfg.com](mailto:mjm@hammondmfg.com)